

The Times Center

HALL SPECIFICS

Dimensions

74' 3" long by 66' 9" wide
Roughly 5,000 sq. ft.

Outer ceiling 12' 10"

Inner ceiling 11' 11"

Walls & Floor

Room has gray wall-to-wall carpet and white walls

Entrance

TheHall has three sets of wooden double-doors that lead out to the lower lobby

Note

The venue strictly prohibits hanging or taping anything to the walls of the space

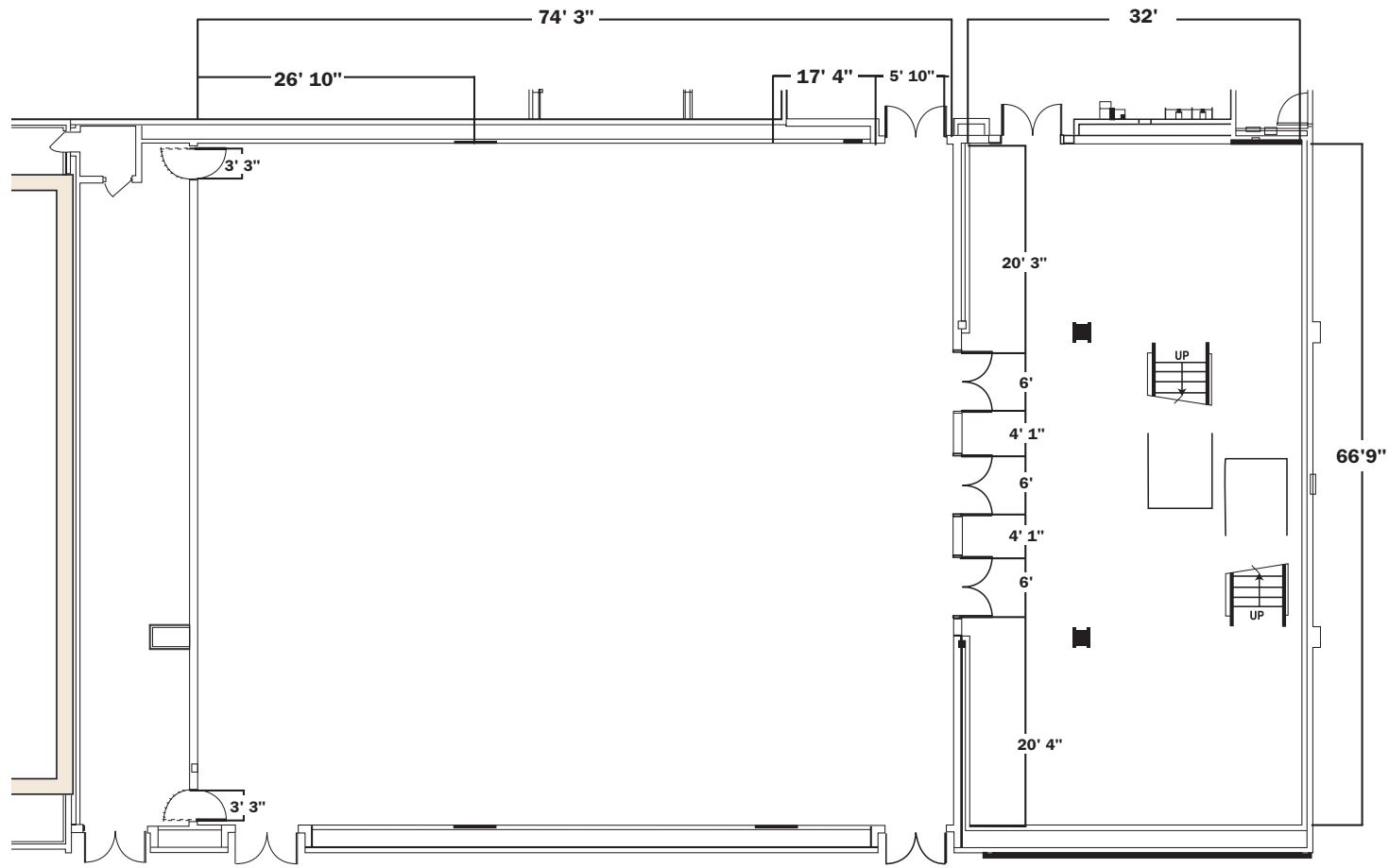

The Times Center

HALL FLOOR PLAN: SEATED DINNER

Banquet Style
Total Seating: 350

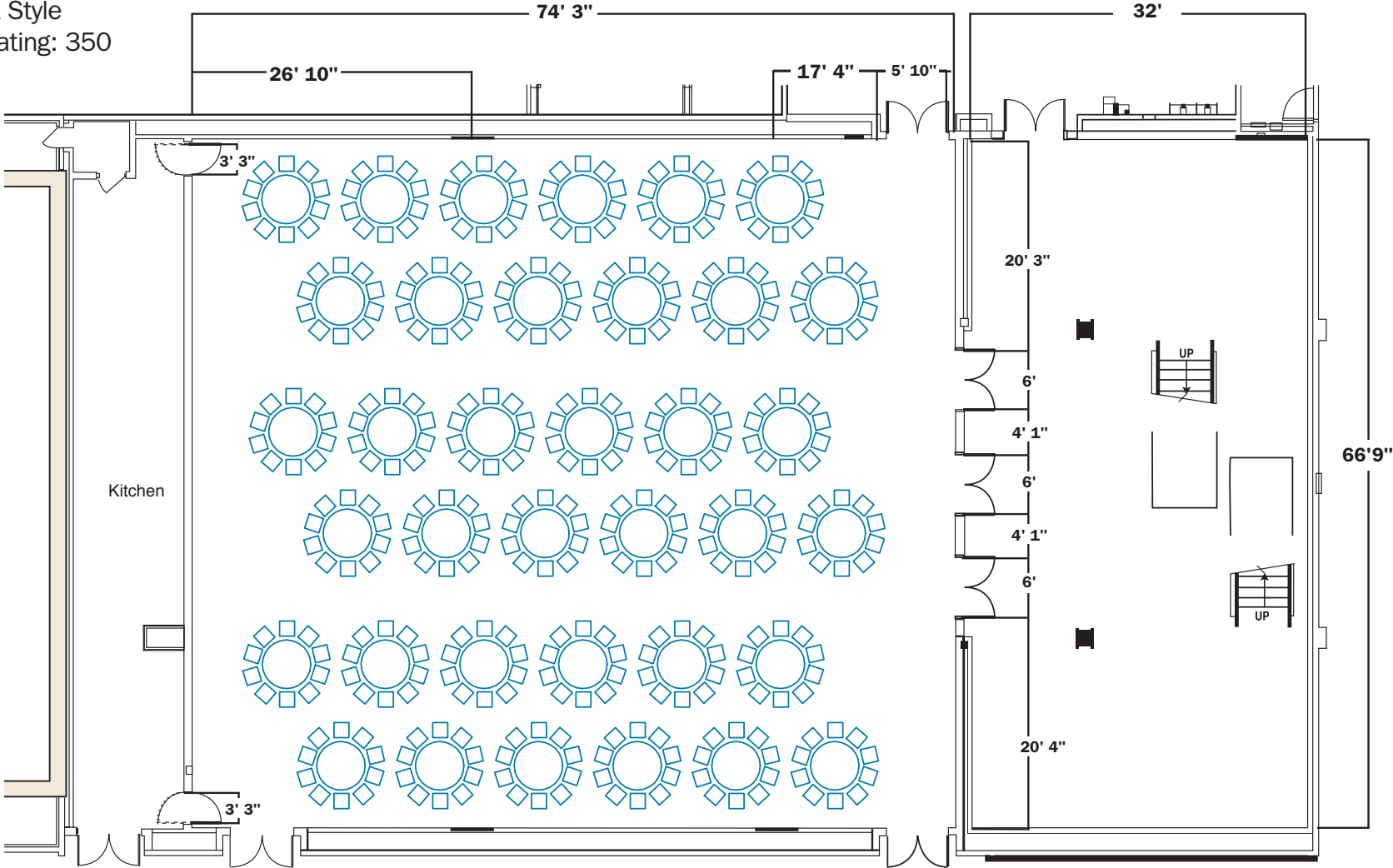

The Times Center

HALL FLOOR PLAN: SEATED DINNER WITH STAGE

Seating: 200

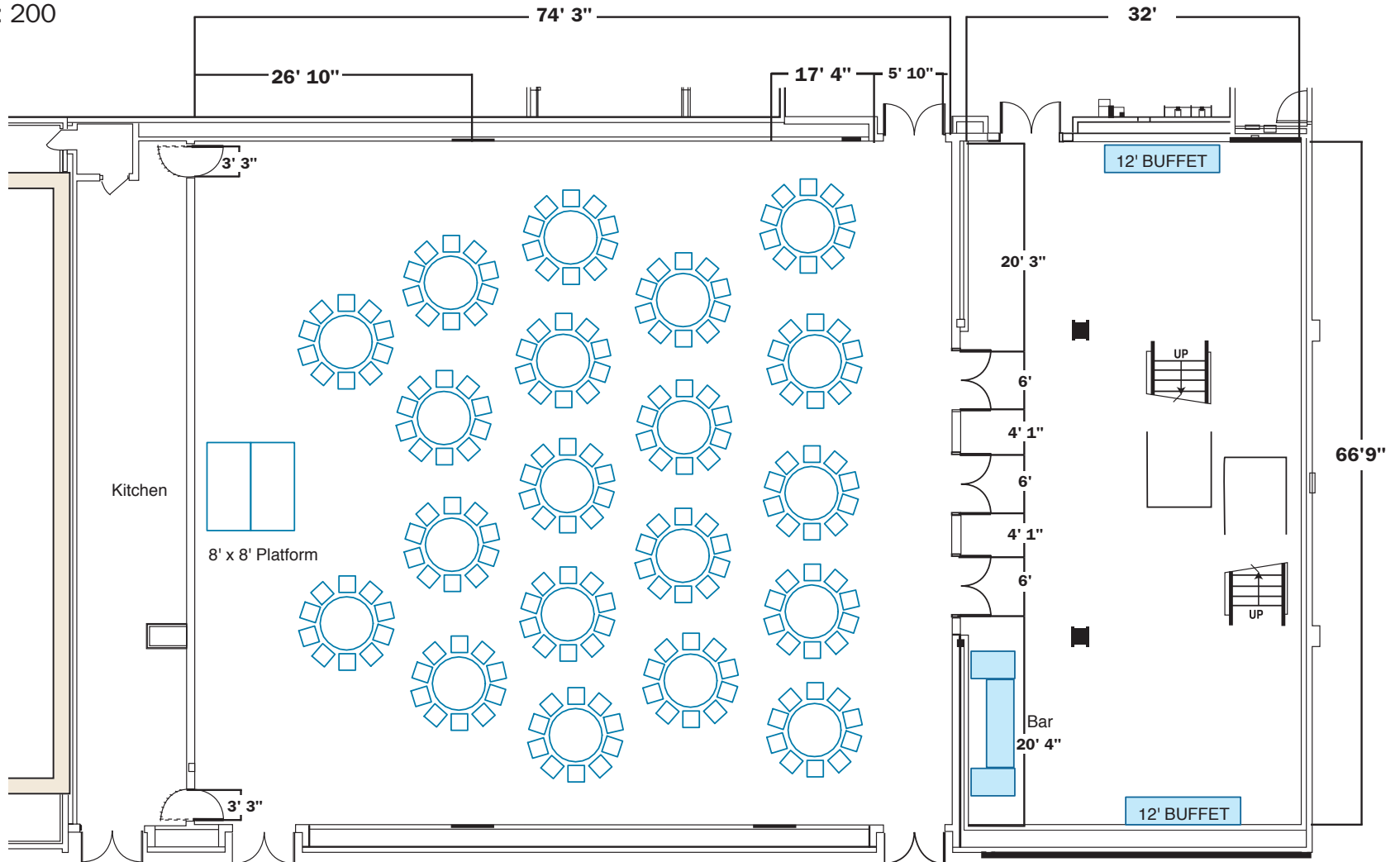

The Times Center

HALL FLOOR PLAN: SEATED DINNER WITH CENTER BUFFETS

Seating: 230

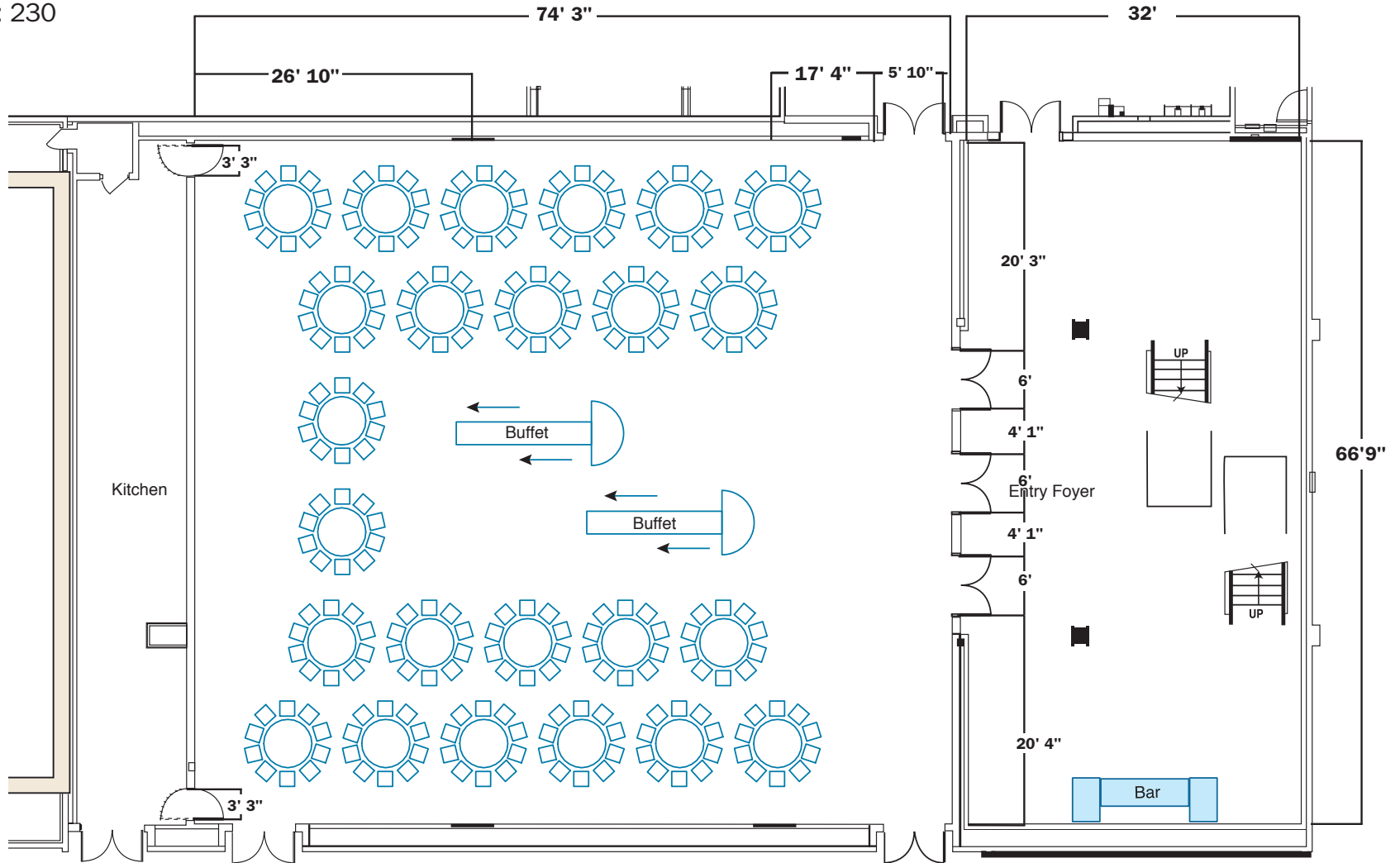

The Times Center

HALL FLOOR PLAN: SEATED DINNER WITH SIDE BUFFETS

Seating: 240

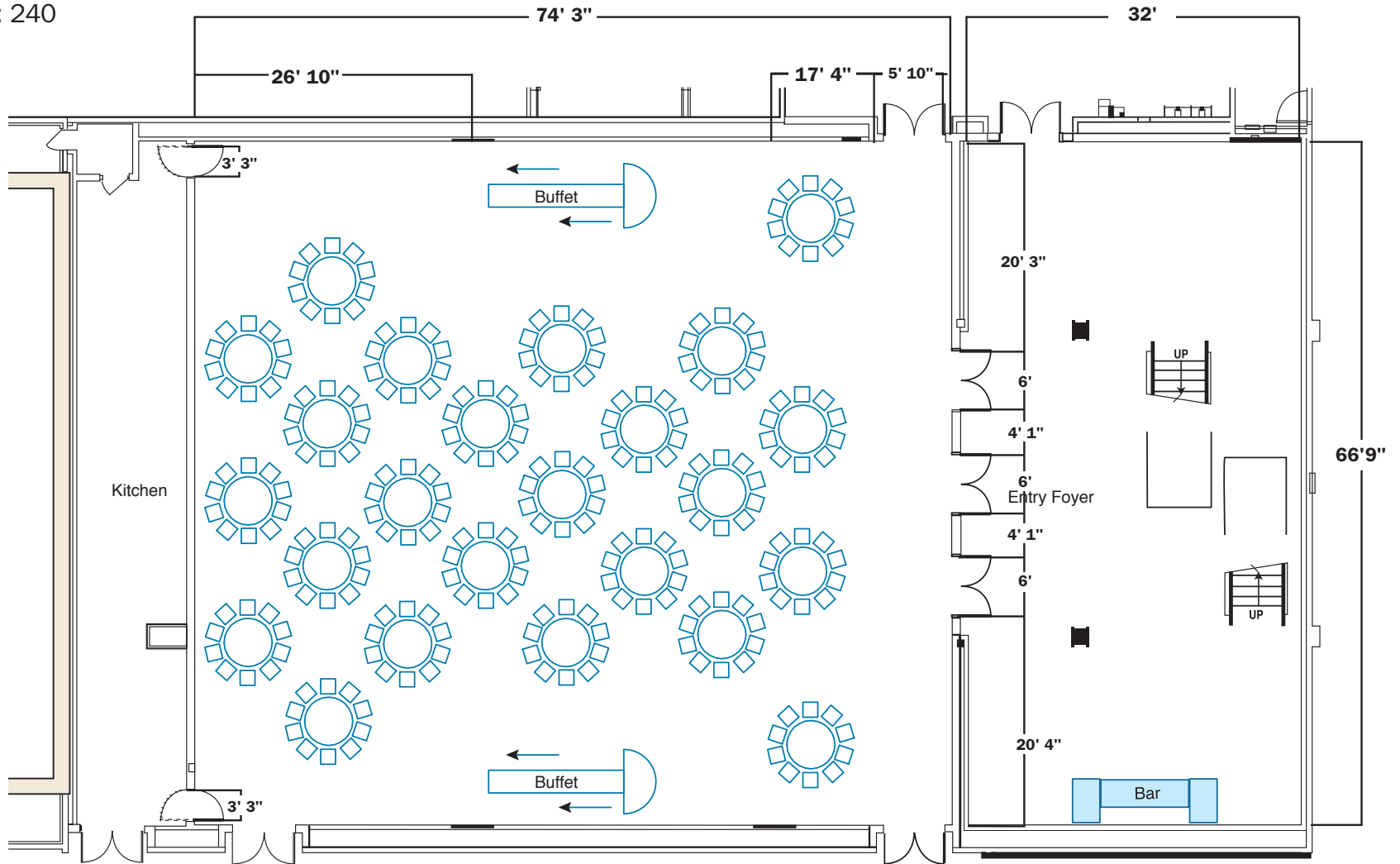

The Times Center

HALL FLOOR PLAN: COCKTAIL RECEPTION

350 – 400 capacity,
including lower lobby

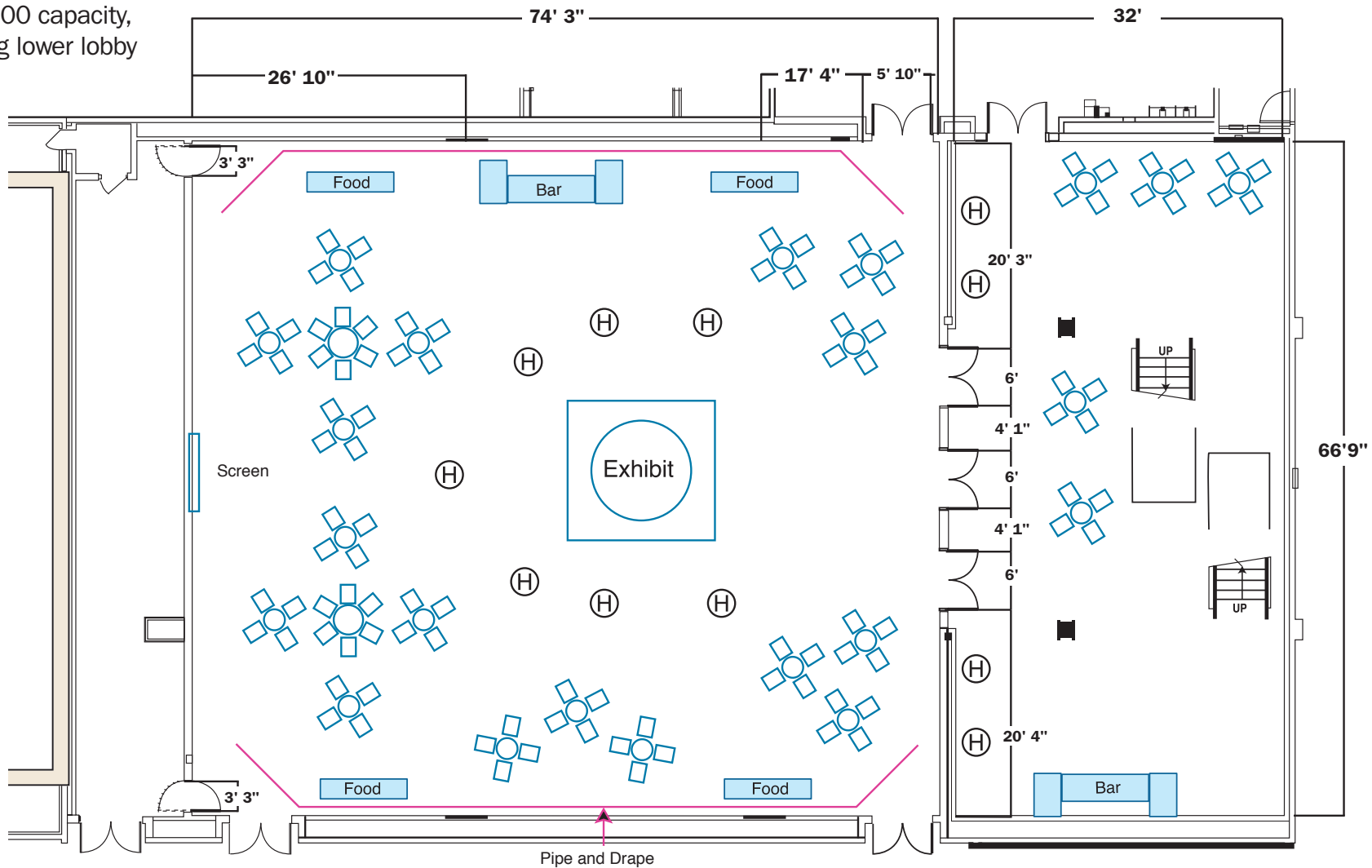

The Times Center

HALL FLOOR PLAN: COCKTAIL RECEPTION WITH CENTER BUFFETS

350 – 400 capacity,
including lower lobby

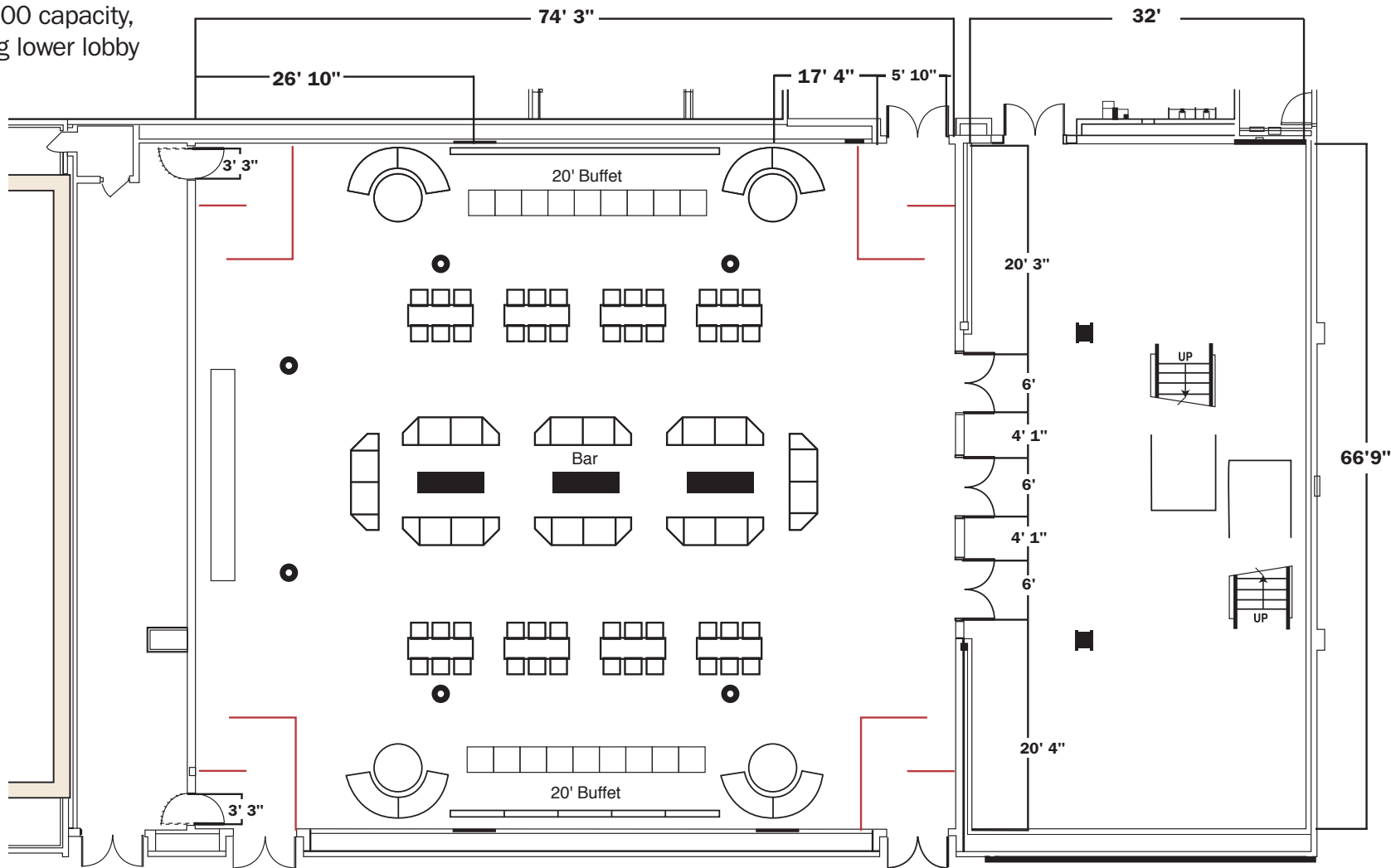

The Times Center

HALL FLOOR PLAN: THEATER STYLE SEATING

Total Seating: 390

